

SPECIFICATION FOR APPROVAL

承 认 书

CUSTOMER

客户名称:

NUMBER

编 号:

DESCRIPTION

品 名: 贴片共模滤波器

QUANTITY

数 量:

PART NO.

型 号: BCCM7660-2-451T01

DATE

日 期:

CUSTOMER PART NO.

客户料号:

NOTE

注 解:

APPROVAL SIGNATURE 客户承认签章

APPROVED BY 核 准	Q. C. DEPT. 品 管	CHECKED BY 核 查	DRAWN BY 制 作

BCCM7660-2-451T01

DC COMMON MODE FILTER

FEATURES

- A chip-type common mode filter for large current applications. Common mode impedance surpasses 450 Ω at 100MHz. Noise is greatly suppressed.
- Capable of handling the highest current(up to 3A) of any chip-type common mode filter.
- Height and size have been considered ,resulting in a compact and light-weight choke coil.Applicable for the miniaturization required to reduce the size and weight of portable equipment.
- The products contain no lead and also support lead-free soldering.
- The product does not contain regulatde substances that are slated to be included in ROHS.



APPLICATIONS

Used for power line noise suppression for any electronic-devices
Used to counter adapter/battery line noise for relatively large electronic devices such as notebook PCs, stand-alone word processors, etc

TEMPERATURE RANGES

Operating	-40to+125°C
Storage(After mount)	-40to+125°C

Part Number System

BCCM 7660 -2 -451 T 01

① ② ③ ④ ⑤ ⑥

- ① Type:BCCM
- ② External Dimensions(L×W) (mm):7.6*6.0
- ③ Number of Lines: 2
- ④ Impedance:451=450 Ω
- ⑤ Packing:Tape & Reel
- ⑥ Management Symbol:01

ELECTRICAL CHARACTERISTICS

Part No.	Impedance (Ω)min[at 100MHz]	DC resistance (m Ω)max[1 line]	Rated current ldc(A)max	Insulation resistance (M Ω)min
BCCM7660-2-451T01	450	30	3	10

BCCM7660-2-451T01

DC COMMON MODE FILTER

TYPICAL ELECTRICAL CHARACTERISTICS IMPEDANCE vs. FREQUENCY CHARACTERISTICS

BCCM7660-2-451T01

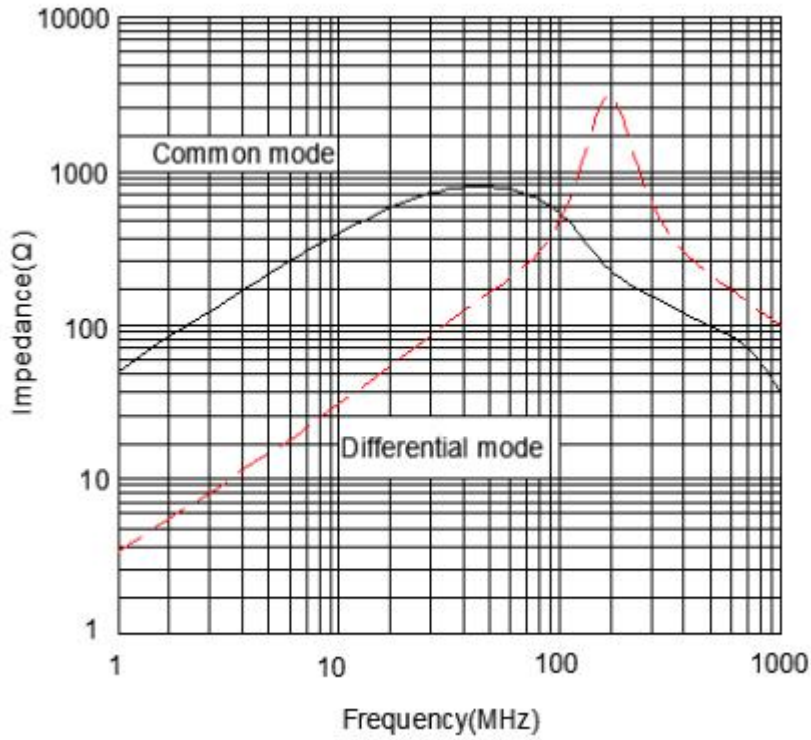

TLCM7660-2-451T01

DC COMMON MODE FILTER

SHAPES AND DIMENSIONS/CIRCUIT DIAGRAM/RECOMMENDED PC BOARD PATTERN (REFLOW SOLDERING)

◆ Dimensions (mm)

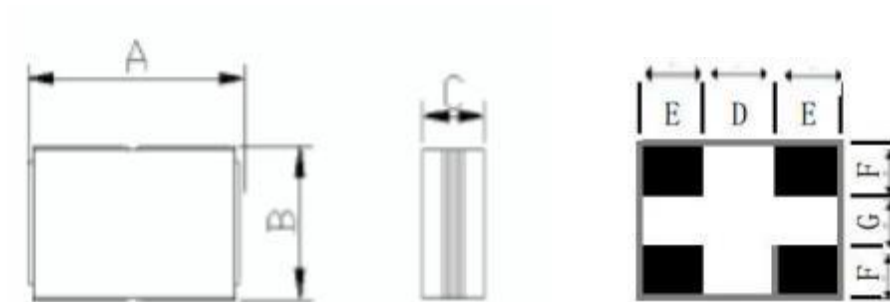

UNIT: mm

A: 7.6 ± 0.5

B: 6.0 ± 0.5

C: 4.3 (MAX)

D: 2.60 E: 2.50

F: 2.10 G: 1.80

◆ Land Pattern (mm)

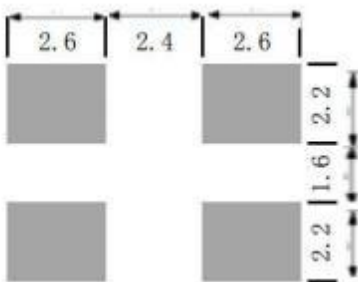

◆ Schematics (Bottom)

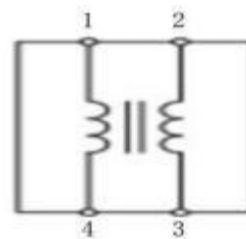

No polarity

TLCM7660-2-451T01

DC COMMON MODE FILTER

Recommended Reflow Temperature Curve

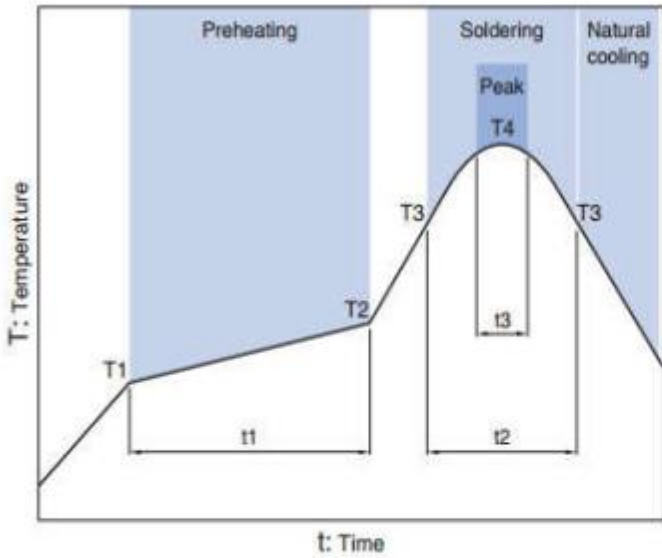

Preheating			Soldering		Peak	
Temp.	Temp.	Time	Temp.	Time	Temp.	Time
T1	T2	t1	T3	t2	T4	t3
150°C	180°C	60 to 120s	230°C	10 to 30s	245°C	5s

Package size (mm)

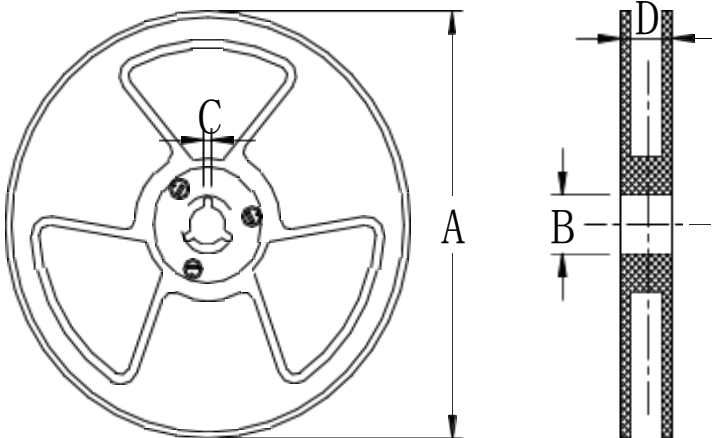

size \ Specs	13"	7"
A	$\Phi 330 \pm 2.0$	$\Phi 178 \pm 2.0$
B	$\Phi 90 \pm 2.0$	
C	2.3	
D	21.5	